

EMBARK

CLASS A DIESEL MOTORHOMES

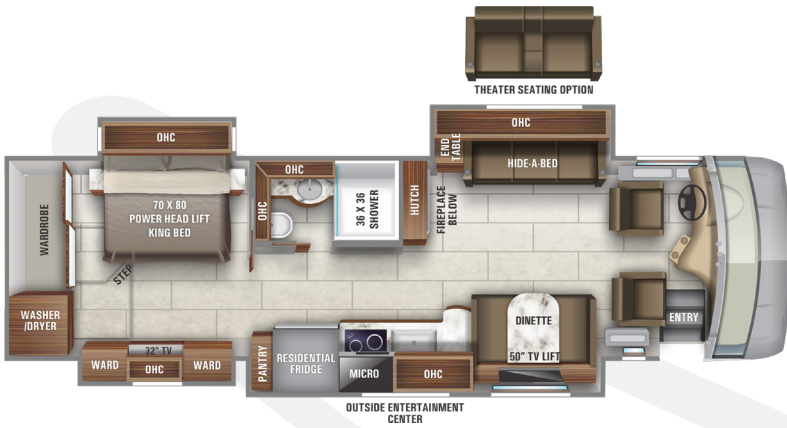

37K

Ext. Lgth: 37' 10" Wheelbase: 236" GVWR: 32,600 lbs.

EXTERIOR PAINT SELECTIONS



Bravado Full-Body Paint



39BH

Ext. Lgth: 39' 11" Wheelbase: 261" GVWR: 36,320 lbs.

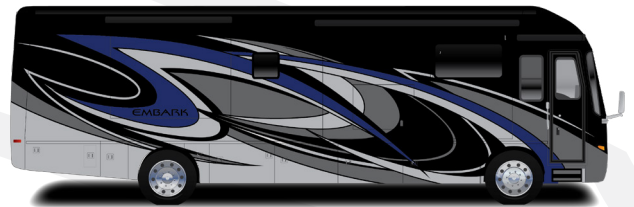

Night Flight Full-Body Paint



39T2

Ext. Lgth: 39' 11" Wheelbase: 261" GVWR: 36,320 lbs.

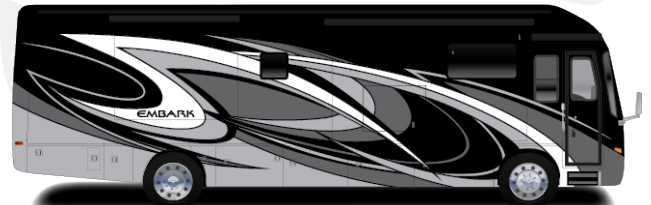

Stargazer Full-Body Paint



Sunhaze Full-Body Paint

STANDARDS & OPTIONS

STANDARD CHASSIS EQUIPMENT

Spartan® K1 raised-rail chassis
 Cummins® B6.7 turbocharged 360 HP engine 800 lb. ft. torque at 1,800 RPM
 Allison® 3,000 MH 6-speed transmission
 Rear-mounted radiator
 170 amp alternator
 750 watt engine block heater
 Variable geometry turbo (VGT) engine brake
 Independent front air suspension (IFS) front axle-12,600 lb. (37K) 14,320 lb. (39BH/39T2)
 Rear axle-20,000 lb. (37K) 22,000 lb. (39BH/39T2)
 4.88 rear axle ratio
 Michelin® 275/80R 22.5" tires
 Tire pressure monitoring system (TPMS) with temperature monitoring
 Bilstein® 46mm shocks
 Equalizer™ hydraulic automatic coach leveling
 Remote air connection
 (2) 12V chassis batteries
 100 gal. fuel tank
 10 gal. DEF tank
 55 degree turning radius
 Spartan® Safehaul tow vehicle air brake system
 10,000 lb. hitch with 7/4-pin plug

STANDARD CONSTRUCTION FEATURES

Roof: One-piece fiberglass with 3/8" plywood decking, 4" arched aluminum trusses, insulation and reflective Flexfoil® (R-24)
 Sidewalls: Vacuum-bonded, high-gloss gelcoat with R-8 bead-foam insulation
 Floors: Vacuum-bonded layers of Darco underbelly, a welded aluminum frame, R-9 bead-foam insulation, 3/8" Structurewood® and 1/4" plywood
 X-Bridge™ bracing welded into chassis frame
 Heated basement storage
 Insulated front and rear caps (R-24)
 Electric-powered slideout rooms
 Steel-reinforced front cap and windshield frame

HEAT, A/C, POWER AND WATER EQUIPMENT

Onan® 8,000 watt diesel generator, with automatic start, on slide-out tray
 2,000 watt pure sine wave inverter with 100 amp battery charger
 (2) L16 AGM batteries (6V/390 amp hrs. ea.)
 50-amp power cord
 Surge protector transfer switch
 (3) 15,000 BTU A/C units with heat pumps [(2)15,000 BTU units with heat pumps on 37K]
 35,000 BTU furnace (37K)/ (1) 20,000 and (1) 30,000 (39BH, 39T2)

10 gal. gas/electric water heater
 Fireplace (37K only)
 24.5 gal. propane tank
 Sani-Con® Macerator holding tank dump system with manual gate valves and manual backup
 Black holding tank sprayer
 City and tank water filtration system
 Winterizing drain system

STANDARD EXTERIOR EQUIPMENT

Power patio awning with LED lights
 Power entrance door awning with LED lights
 Slideout awnings
 Window awnings
 Frameless, dual-pane, tinted, safety-glass windows
 Grab handle and keypad system for keyless entry
 Exterior 39" LED TV on adjustable TV bracket
 Heated, remote control, side-view mirrors with integrated cameras
 Diamond Shield™ front protective film mask
 Halogen high/low beam headlights and fog lights
 Daytime running lights
 LED marker lights, turn lights, license plate light, accent lights, & docking lights
 Full-width rear mudflap
 Winegard® TRAV'LER satellite dish DIRECTV®- standard with USA option
 Winegard® TRAV'LER satellite dish Shaw TV- standard with CSA option
 Winegard® Rayzar Z1 TV antenna
 Winegard® WIFI extender with 4G/LTE
 Slideout basement storage tray
 Solar power prep
 Exterior utility center
 Sikken's custom full-body paint
 LED third brake light

COCKPIT AMENITIES

Xite™ 360° camera system that displays on digital dash screen
 Valid 12.3" digital dash with quad core graphics processor with ability to display on-board diagnostics, traditional instrument cluster, 360° camera system or Rand McNally™ GPS navigation.
 Xite™ XSG3 infotainment system with navigation, Bluetooth, Sirius XM™ and AM/FM tuner
 Ultra-Vision® one-piece wrap-around tinted windshield
 Tilt and telescoping steering wheel with integrated controls for cruise, wipers, radio controls and Bluetooth phone functionality
 Power adjustable driver and passenger seats
 Powered flush stepwell cover
 Powered front sun visors and privacy shade
 Power adjustable brake and accelerator pedals
 Wrapped dash with molded side consoles

(2) dual USB ports and (2) 12V socket for charging

STANDARD INTERIOR EQUIPMENT

JAYCOMMAND™ powered by VegaTouch (mobile app available)
 Sony® Blu-Ray® player
 50" Insignia™ LED TV
 Insignia™ sound bar
 Whirlpool® stacked washer and dryer
 Premium furniture
 Hand-laid polished porcelain floor tiles
 Recessed, 12V, LED lighting
 Decorative ceiling feature with integrated accent lighting
 Manual solar day shades and blackout night shades
 Central vacuum system
 Removable screen on entry door

STANDARD KITCHEN EQUIPMENT

Window with slider and screen
 Whirlpool® stainless steel residential refrigerator with ice maker and water dispenser
 Induction cooktop
 1.5 cu. ft. convection microwave oven
 Solid-surface countertops with stainless-steel sink
 Fan-Tastic power exhaust fan with intake

STANDARD BEDROOM EQUIPMENT

King-sized pillow top mattress on tilt bed
 32" Insignia™ LED TV
 Sony® Blu-Ray® player

STANDARD BATHROOM EQUIPMENT

Solid-surface countertops with integrated sink
 One-piece fiberglass shower with skylight
 Aqua View SHOWERMISER™ water saving system
 Thetford® Aqua Magic® toilet with foot flush
 Fan-Tastic power exhaust fan with intake

STANDARD SAFETY EQUIPMENT

Combination carbon monoxide detector and LP gas alarm
 Porch light
 Smoke alarm

OPTIONS

Canadian standards (CSA)
 Theater seating with power recline
 Winegard® in-motion satellite dome
 Winegard® TRAV'LER satellite dish with Dish Network®



Scan QR code for more information

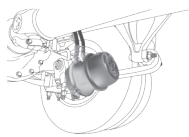

FULL AIR BRAKES

Deliver robust stopping power, even on grades

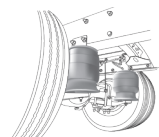

FULL AIR SUSPENSION

Softens ride and improves handling

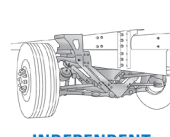

INDEPENDENT FRONT SUSPENSION

For more precise steering and less body-roll on turns

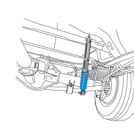

BILSTEIN® SHOCKS

Eliminate excessive sway and bounce



MICHELIN® XZE TIRES

Commercial-grade tires built for long hauls and heavy loads

EMBARK FLOORPLANS	EXTERIOR LENGTH	EXTERIOR WIDTH	EXTERIOR HEIGHT (WITH A/C)	INTERIOR HEIGHT	WHEEL BASE	FRESH WATER CAPACITY (INCLUDING WATER HEATER)	GRAY WASTE WATER CAPACITY	BLACK WASTE WATER CAPACITY
37K	37' 10"	101"	12' 10"	84"	236"	100	62	41
39BH	39' 11"	101"	12' 10"	84"	261"	100	62	41
39T2	39' 11"	101"	12' 10"	84"	261"	100	62	41

Some specs at the time of print may include estimates, for the most updated information, please visit Jayco.com

It is important for your safety and enjoyment that you are aware of the weights and tow ratings of the RV you select. Consult a competent advisor for questions or advice. Whether you are new to RVing or a veteran, get a feel for the performance of your RV before heading out on the roadways. When you tow a vehicle with your RV, you must drive differently than when you drive a single vehicle. Practice hooking up, driving, backing up and braking in a safe environment or seek out professional instruction. Jayco affixes a weight label to each RV which lists weight information for that vehicle. Refer to that label to verify the vehicle will meet your requirements. See specifications chart above.

Gross Vehicle Weight Rating (GVWR): The maximum permissible weight of the motorhome, including the Unloaded Vehicle Weight (UUV) plus passengers, personal items, all cargo, fluids, options and dealer-installed accessories. The GVWR is equal to or greater than the sum of the UUV and the Cargo Carrying Capacity.



TRAVEL WITH CONFIDENCE • NO ONE OFFERS A BETTER WARRANTY

At Jayco, we build our RVs to handle every adventure, then back them with our industry-leading 2+3 limited warranty. Our 2-year limited warranty has you covered for 2 camping seasons. That's 730 days. In addition, our 3-year structural limited warranty has you covered for 3 camping seasons or 1,095 days. You won't find a better limited warranty in the business, because the only strings that we attach are those that deliver the ultimate in reliability. That's the Jayco difference. So go explore. For a copy of our 2-year limited + 3-year limited structural warranty with complete terms and conditions, please contact your local Jayco dealer.



Generations of family fun.

